

TIG TORCH 9 SERIES

125 AMP AIR COOLED

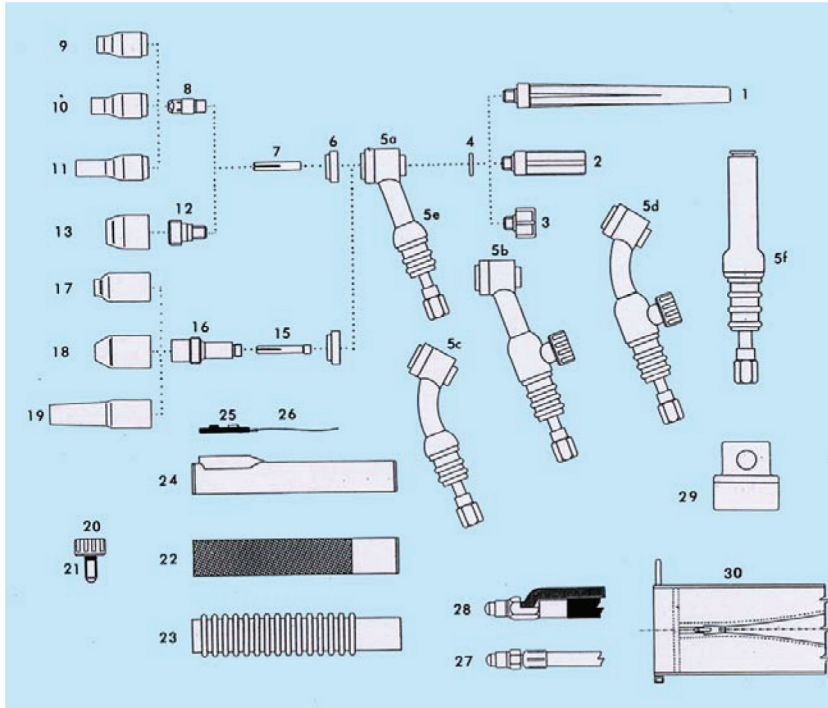

Torch Packages

WP-9-12-1	WP-9-12-2
WP-9-25-1	WP-9-25-2
WP-9V-12-1	WP-9V-12-2
WP-9V-25-1	WP-9V-25-2

Item	Part No	Description
1	41V24	Back Cap, Long
2	41V35	Back Cap, Medium
3	41V33	Back Cap, Short
4	98W77	Back Cap O-Ring
6	598882	Gasket / Insulator
14	54N01S	Insulator
20	VS-2	Valve Stem
21	VS-0	O-Ring
22	H100	Handle, Texture
23	H100R	Handle, Ribbed

Item	Part No	Description	Item	Part No	Description
5a	WP-9	Torch Body 125 Amp., Rigid	26	SW-2	Switch On/Off
5b	WP-9V	Torch Body 125 Amp., w/Valve	27	57Y01R	Power Cable, 12.5 Ft. 1 Pc Rubber
5c	WP-9F	Torch Body 125 Amp., Flex Head		57Y03R	Power Cable, 25 Ft. 1 Pc Rubber
5d	WP-9FV	Torch Body 125 Amp., Flex Head w/Valve	28	57Y01-2BR	Power Cable, 12.5 Ft. 2 Pc Braided
5e	WP-9HP	Torch Body 125 Amp., Hard Plastic		57Y03-2BR	Power Cable, 25 Ft. 2 Pc Braided
5f	WP-9P	Torch Body 125 Amp., 180 Degree	29	105Z57	Power Cable Adapter
24	B-S1	Rubber Boot (SW1 Switch Only)	30	CC-3-10	Cable Cover 3"x 10 feet
	B-S2	Rubber Boot (SW2 Switch Only)		CC-3-22	Cable Cover 3"x 22 feet
25	SW-1	Switch Momentary	NS	AK-1	Accessory Kit

Item	Description	Part No						
ELECTRODE SIZE		0.020"	0.020"	0.040"	1/16"	3/32"	1/8"	1/8"
		(0.5 mm)	(0.5 mm)	(1.0 mm)	(1.6 mm)	(2.4 mm)	(3.2 mm)	(3.2 mm)
NOZZLE SIZE		#3	#4	#5	#6	#7	#8	#10
7	Collet	13N20	13N20	13N21	13N22	13N23	13N24	13N24
8	Collet Body	13N25	13N25	13N26	13N27	13N28	13N29	13N29
9	Alumina Nozzle	-	13N08	13N09	13N10	13N11	13N12	13N13
10	Lava Nozzle	-	13N14	13N15	13N16	13N17	13N18	13N19
11	Long Lava Nozzle	796F70	796F71	796F72	796F73	-	-	-
12	Small Gas Lens	-	45V41	45V42	45V43	45V44	45V45	-
13	Alumina Nozzle	-	53N58	53N59	53N60	53N61	53N61S	-
15	Gas Lens Collet	-	13N20L	13N21L	13N22L	13N23L	13N24L	-
16	Med. Stubby Gas Lens	-	45V29S	45V24S	45V25S	45V26S	45V27S	-
17	Alumina Nozzle	-	54N18	54N17	54N16	54N15	54N14	54N19
18	Lava Nozzle	-	54N35	54N34	54N33	54N32	54N31	-
19	Long Alumina Nozzle	-	-	54N17L	54N16L	54N15L	54N14L	-

AUTHORISED DISTRIBUTOR